

05 / Keys & Bluetooth Status

Bluetooth	Flashing	Disconnected
	Steady On	Connected

Keys	<	Short-press on the main menu; the tray will rotate clockwise by one compartment. Long-press to review the feeding plans! Short-press on the setting feeding plan interface to switch and set the feeding plan meal number, reducing hours and minutes. Short-press to review feeding plans, switch between feeding plans.
	≡	Double-click on the panel to set the device's time, short-press to set feeding plans, and long-press for 5 seconds to restore the factory settings. Short-press on the feeding plan setting interface to switch between hours and minutes, long-press to return to the main interface.
	>	Short-press on the main menu; the tray will rotate counter-clockwise by one compartment. Long-press to review the feeding plans! Short-press to switch between feeding plans, increase hours and minutes when setting time. Short press to review feeding plans, switch between feeding plans.

06 / Specification

Model: PF006
Power Input: 5V=1A
Communication: Bluetooth
Capacity Per Compartment: 170ml(about 120g)
Suitable Pets: Cats and Small Size Dogs

Size: 320x320x83mm
Net Weight: About 1134g
Material: ABS
Warranty: 1 Year

Manufacturer: SkyRC Technology Co., Ltd.
Address: 4,5,8/F, Building No.4, Meitai Science Park, Guangang South Road, Guihua, Guanlan, Longhua New District, Shenzhen 518110, China

- ### 07 / Precautions
- If the feeder is powered off and then powered on, the time setting needs to be reset.
Method 1: Connect the feeder with the App. After the connection is established, the feeder will automatically synchronize the phone's time.
Method 2: If the feeder is not connected to the app, you can set the time on the main interface.
 - Never place other sundries on the top of the feeder.
 - This feeder is for both dry and wet food.
 - The base of the feeder is strictly prohibited from being immersed in liquid.
 - If the feeder is not used for 5 minutes, it will automatically turn off the screen to save power.
 - Never fill food beyond the edge of the tray compartment to avoid malfunction.
 - When the feeder alerts on low battery, please replace the battery in time. If you are not going to use the device for a while, we recommend removing the batteries.
 - Please get the power cable covered or well-organized to prevent pets from chewing.
 - This feeder is suitable for cats and Small Size Dogs.

08 / Warranty Terms

Within the period of warranty, if the product fails with no fault of user operations, it will be repaired at Petoneer's expense. The warranty will not cover product failure in examples below:

- Intentional damage to the product by the user or third party.
- Failure to operate or maintain the product following the (QIG) Quick Installation Guide Instructions.
- Failure by natural wear and tear including but not limited to scratching, corrosion, oxidation and rusting.
- Failure by non-authorized repair of the product including but not limited to user's own or third-party repairing attempts or modifications.

All Pictures shown in the manual are for illustration purpose only.
Actual product may vary due to product enhancement.

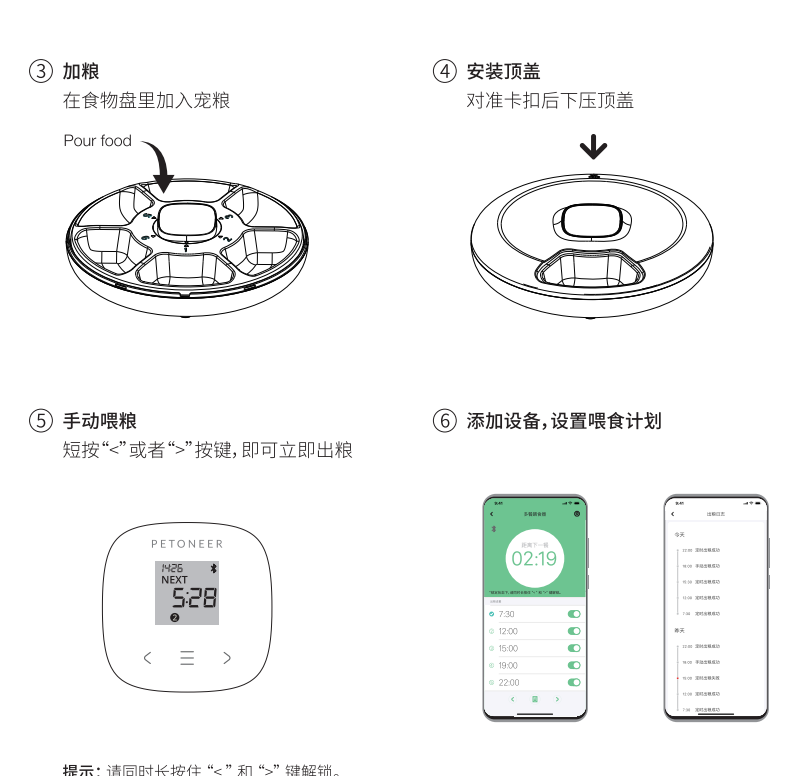
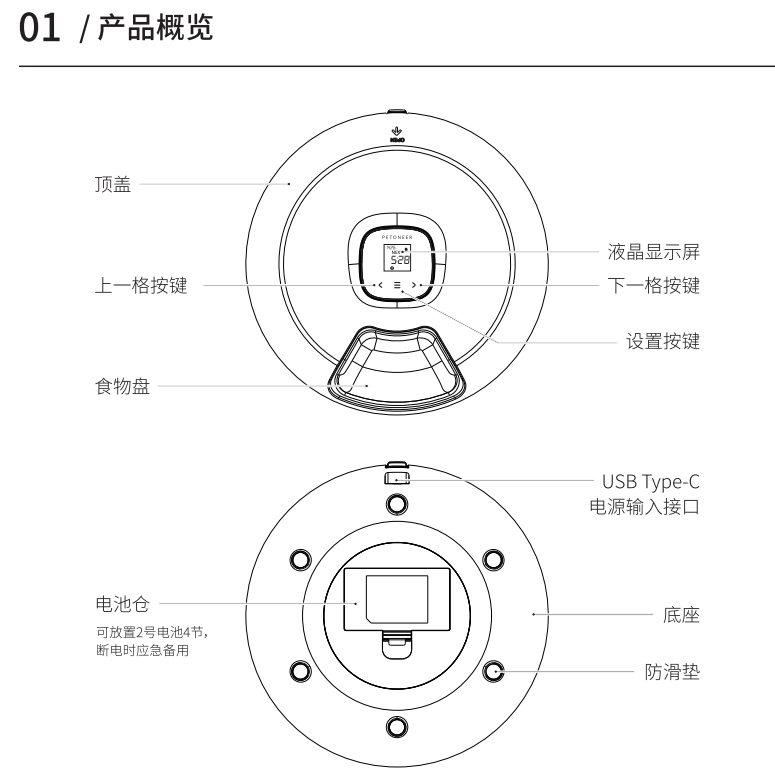

05 / 蓝牙 & 按键

蓝牙	蓝牙图标闪烁	未连接状态
	蓝牙图标常亮	已连接状态
按键	<	主界面短按, 转盘顺时针转动一格, 长按, 进入查看喂食计划界面。 设置喂食计划界面短按, 切换设置喂食计划餐号, 减少小时和分钟。 查看喂食计划界面短按, 切换查看喂食计划餐号。
	≡	主界面双击, 设置本机时间, 短按进入设置喂食计划界面, 长按5秒恢复出厂设置。 设置喂食计划界面短按, 切换小时和分钟, 长按返回主界面。
	>	主界面短按, 转盘逆时针转动一格, 长按, 进入查看喂食计划界面。 设置喂食计划界面短按, 切换设置喂食计划餐号, 增加小时和分钟。 查看喂食计划界面短按, 切换查看喂食计划餐号。

06 / 基本参数

产品型号: PF006
输入电源: DC 5V 1A
通讯: 蓝牙
单格容量: 170ml(约120g)
适用对象: 猫及小型犬

产品尺寸: 320x320x83mm
产品净重: 约1134g
产品材质: ABS
执行标准: Q/TK 002-2019
保质期: 1年

服务热线: 400-808-5869
服务网址: www.petoneer.com

制造商: 天空创新科技(深圳)有限公司
制造地址: 深圳市龙华区观澜街道桂花社区观光路美泰工业园4栋4,5,8层

- ### 07 / 注意事项
- 喂食器断电再上电, 需要重新设置时间。
方法一: 用手机app连接喂食器, 连接成功后, 喂食器会自动同步手机时间。
方法二: 如果未连接app, 可以在喂食器主界面设置时间。
 - 喂食器顶部禁止放置其他杂物。
 - 本产品干粮湿粮通用。
 - 喂食器机体严禁浸入液体中。
 - 喂食器5分钟未使用, 将自动熄屏。
 - 请不要将宠粮填充超过食物盘边缘, 以免引起设备故障。
 - 喂食器低电量报警时, 请及时更换电池。如长期不用, 请将电池取出。
 - 请做好电源线遮挡或收纳, 以防宠物撕咬电线。
 - 本机适用于猫或小型犬。

08 / 保修条款

在保修期限内, 对于正常使用Petoneer产品过程中, 由于非人为导致的损坏, 所产生的维修费用和人工费用, 由Petoneer承担。以下情况导致的维修不在保修条款包含中:

- 故意行为导致的损坏。
- 未按照产品使用说明书指引使用、保养该产品。
- 设备正常磨损、腐蚀、氧化、锈蚀、磨损等原因导致的损坏。
- 因在非Petoneer授权维修代理店或用户自身进行维修、改造、清洗而造成的损坏。

* 为了提供更好的产品, 我们会定期进行产品改良, 产品实物可能与说明书有差异。

www.petoneer.com